



OAKFIELD



South Cliff, Eastbourne
£1,200 Per Calendar Month



South Cliff, Eastbourne

Situated within the ever-popular Regency Court in Eastbourne, this beautifully presented two-bedroom basement flat offers an impressive amount of space and a good standard of finish throughout. The property has been thoughtfully maintained and styled, creating a welcoming and comfortable home that feels both modern and practical.

The flat comprises two generously sized double bedrooms, both offering plenty of room for furnishings and storage. The living accommodation is particularly spacious, providing a versatile area for relaxing and entertaining, while still benefiting from a bright and airy feel despite its basement setting.

The layout has been well designed to maximise space and flow, ensuring each room feels open and functional. The overall presentation is excellent, allowing a tenant to move straight in with ease. The property is available either furnished or unfurnished, giving flexibility to suit individual preferences and requirements.

Positioned in a desirable Eastbourne location, Regency Court is conveniently close to a range of local amenities, transport links, and the seafront, making it an attractive choice for those seeking both comfort and convenience.

This is a fantastic opportunity to secure a spacious and well-presented home in a highly regarded area.

Please note:
An annual household income of £36,000 per annum is required.





Living Room
19'1" x 11'10" (5.82 x 3.63)

Kitchen
16'6" x 8'9" (5.03 x 2.67)

Bedroom One
16'7" x 13'3" (5.08 x 4.04)

Bedroom Two
13'3" x 10'11" (4.04 x 3.33)

Bathroom
5'8" x 4'9" (1.73 x 1.47)

Council Tax Band C -£2051.34 per anum



Floor Plan

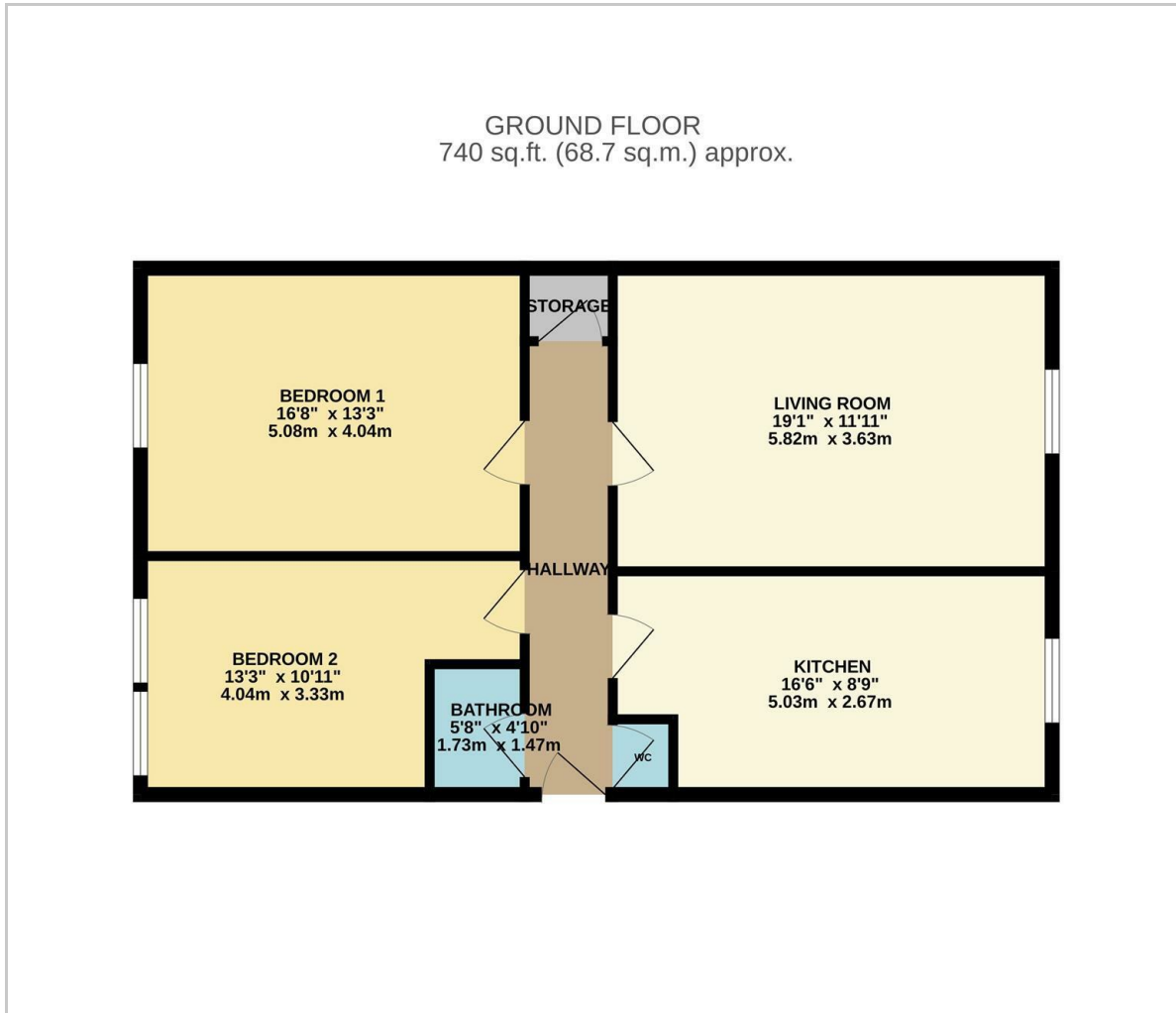

Viewing

Please contact us on 01323 405553 if you wish to arrange a viewing appointment for this property or require further information.

These particulars, whilst believed to be accurate are set out as a general outline only for guidance and do not constitute any part of an offer or contract. Intending purchasers should not rely on them as statements of representation of fact, but must satisfy themselves by inspection or otherwise as to their accuracy. No person in this firm's employment has the authority to make or give any representation or warranty in respect of the property.

35 Cornfield Road, Eastbourne, East Sussex, BN21 4QG
eastbourne@oakfieldproperty.co.uk

Area Map



Energy Efficiency Graph

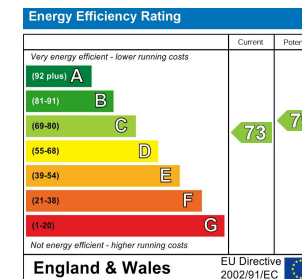

01323 405553
www.oakfieldproperty.co.uk